

Natural Ground Contour Note:

Natural ground contours are at 0.5 metre intervals.  
Scale 1:100 - Lengths are in Metres.

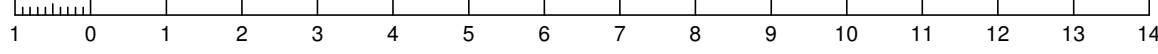

AJS SURVEYS  
CONTOUR & DETAIL SURVEY

17 Judd Street, Gumdale, Qld 4154

P: 07 3823 2144 E: mail@ajs.net.au

W: www.ajs-surveys.com.au

PLAN REF: T0365-D1

LEGEND

- \* LIGHT POLE
- OP ORIGINAL PEG
- POWER POLE
- ☒ FIRE HYDRANT
- ☑ VALVE
- ⊗ SEWER MANHOLE
- ☒ ROOFWATER PIT
- ☒ POWER BOX
- ☒ TELSTRA PIT
- ☒ RETAINING WALL
- ☒ STORMWATER MANHOLE
- ☒ GAS SUPPLY/GAS CYLINDER
- ▲ TEMPORARY BENCH MARK (TBM)
- ☒ PERMANENT SURVEY MARK
- ☒ GULLY GRATE
- ☒ WATER METER
- ☒ SIGN
- ☒ HEADWALL/CROSSOVER
- ☒ ROCK WALL
- ☒ PALM
- ☒ TREE

Note:

Council records note that this lot may be affected by combined drainage.

Subject lot boundary dimensions and area are derived from field survey.

Levels shown on this plan are correct in relation to the benchmarks placed on this plan. AJS Surveys accepts no responsibility for any subsequent plans or works that do not use the same level datum as shown on this plan.

Subject title has not been obtained, therefore AJS Surveys can not certify that no easements affect this lot. A full title search should be carried out prior to any construction.

Green contour lines denote "ground level" as defined by BCC Cityplan 2014.

This plan has been prepared for the purpose of designing new constructions and should not be used for any other purpose.

Certificate of Title for this site has not been obtained. Unless noted otherwise only visible services have been located.

Prior to any demolition, excavation or construction on the site, the relevant authorities should be contacted for accurate location of all services.

31 Judge Street, Kalinga  
Lots 15 & 16 on RP 19480

LEVEL DATUM:  
AHD

DERIVED FROM PSM 46165  
(RL 12.636m)

DRAWING SCHEDULE - Existing Drawings

Dwg	Drawing Name	Rev
SD01	Existing Site Plan	A
SD02	Existing Floor Plans	B
SD03	Existing Elevations	B

LODGED

6/11/2019

BCC DS

Existing Site Plan

1:100

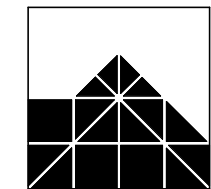

IAN WEBB

ARCHITECT  
60 BANKS ST. NEWMARKET Q. 4051  
PH 07 3856 2855 FAX 07 3356 0419

COPYRIGHT:  
THIS DESIGN IS THE  
PROPERTY OF IAN  
WEBB (R-ARCH) AND  
SHALL NOT BE  
REPRODUCED WHOLLY  
OR IN PART WITHOUT  
HIS WRITTEN  
PERMISSION.

CLIENT: PROJECT KALINGA  
PROJECT: ADDITION & ALTERATION to EXISTING RESIDENCE  
LOCATION: 31 JUDGE STREET, KALINGA

AMENDMENTS:

DRAWN BY:	LM	JOB No:	4142
DATE:	Nov 2018	SHEET No:	SD01
SCALE AT A1:	1:100	REVISION:	A



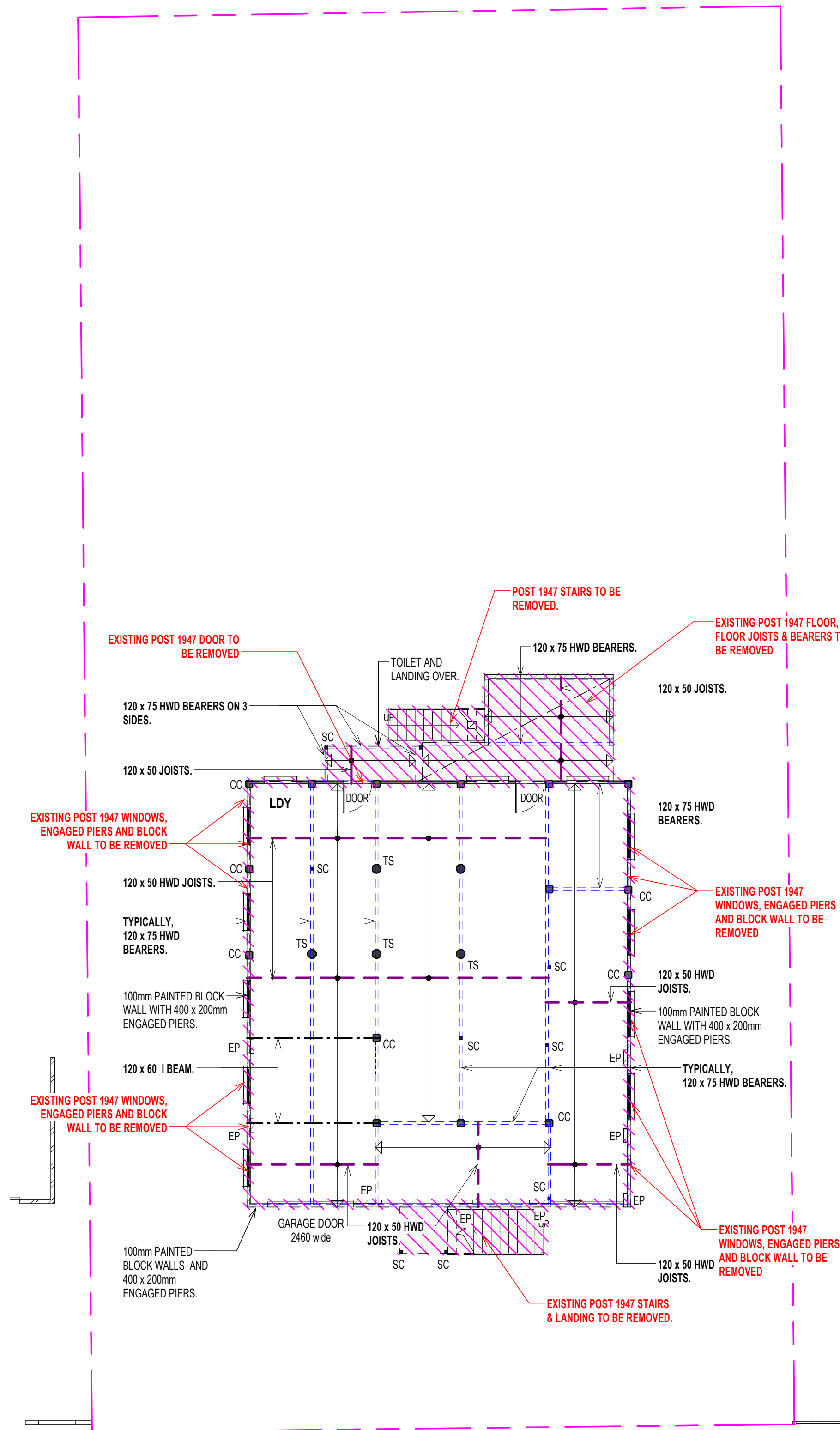
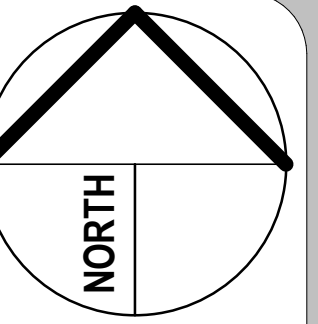

JUDGE STREET

1 Existing Lower Floor Plan showing Schedule of Demolition  
1 : 100

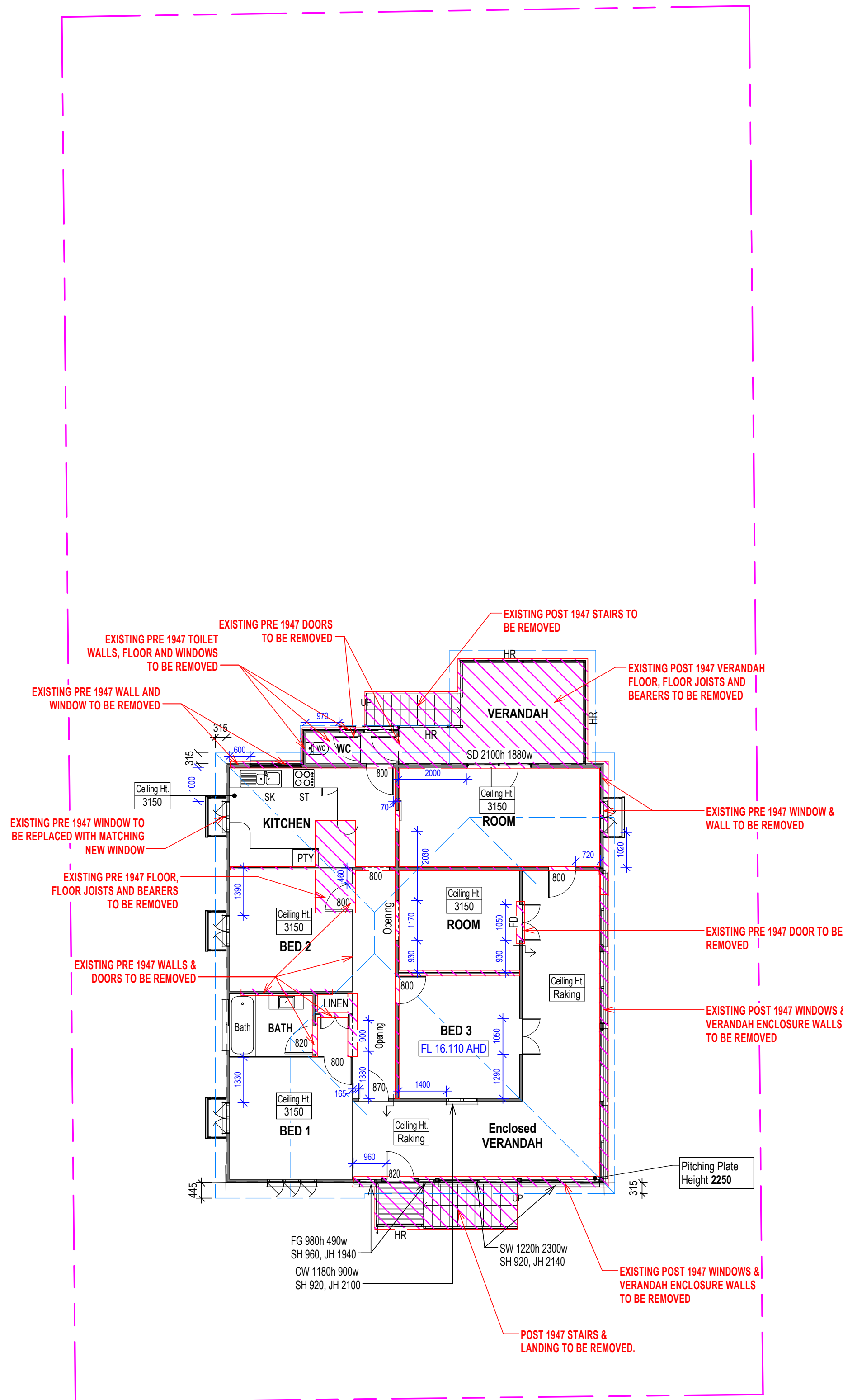

2 Existing Upper Floor Plan showing Schedule of Demolition  
1 : 100

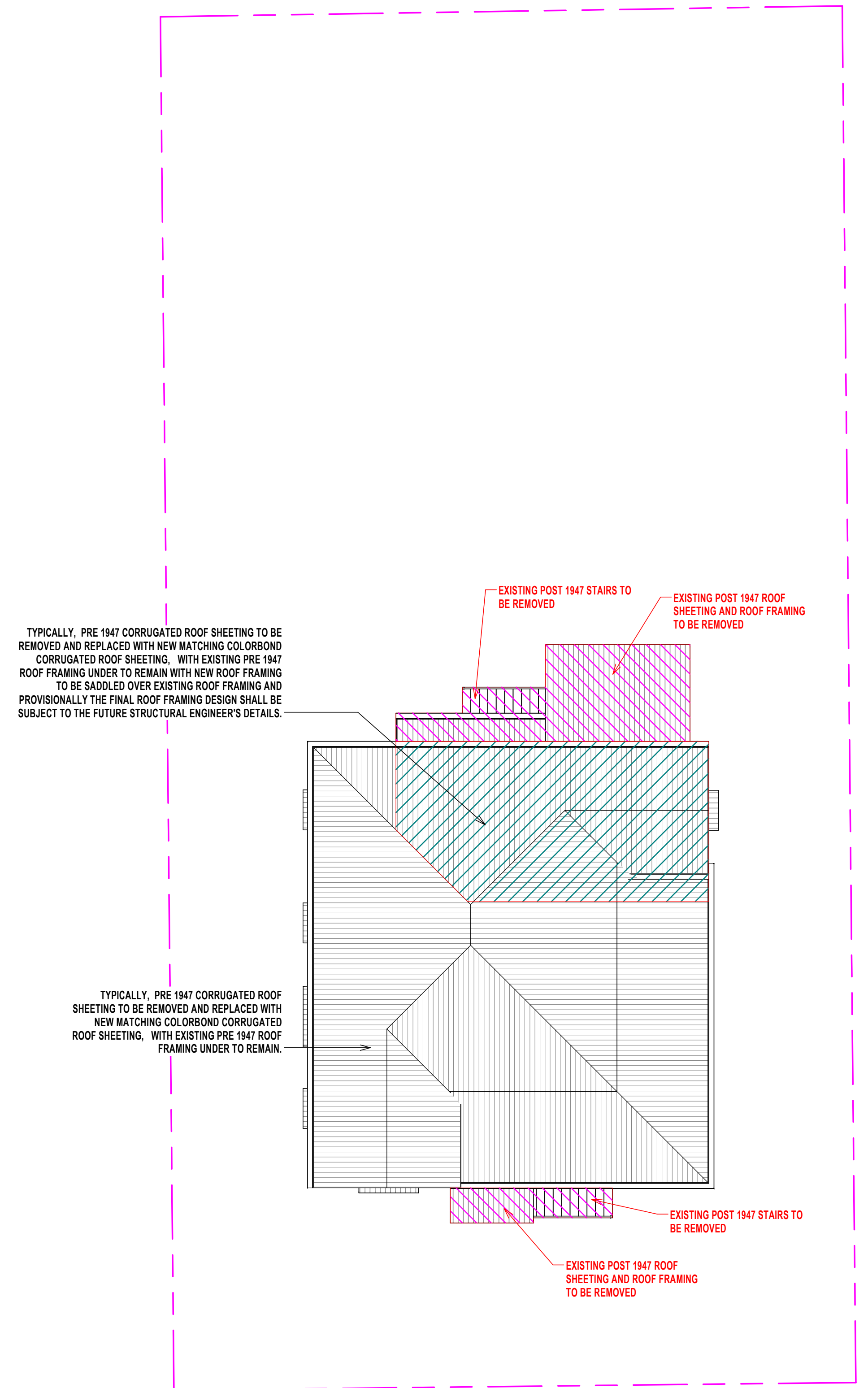

3 Existing Roof Plan showing Schedule of Demolition  
1 : 100

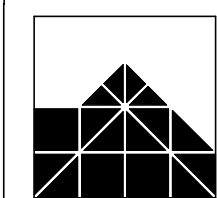

IAN WEBB

ARCHITECT  
60 BANKS ST. NEWMARKET Q. 4051  
PH 07 3856 2855 FAX 07 3356 0419

COPYRIGHT:  
THIS DESIGN IS THE  
PROPERTY OF IAN  
WEBB (B-ARCH) AND  
SHALL NOT BE  
REPRODUCED WHOLLY  
OR IN PART WITHOUT  
HIS WRITTEN  
PERMISSION.

CLIENT: PROJECT KALINGA  
PROJECT: ADDITION & ALTERATION to EXISTING RESIDENCE  
LOCATION: 31 JUDGE STREET, KALINGA

AMENDMENTS:		
A	Completed Existing Upper Floor Plan. Added additional notation to Lower Floor Plan. Added existing Roof Plan	14.01.19 L.M.
B	Notes amended	01.11.19 T.J.A.

DRAWN BY:	LM	JOB No:	4142
DATE:	Nov 2018	SHEET No:	SD02
SCALE at A1:	1 : 100	REVISION:	B



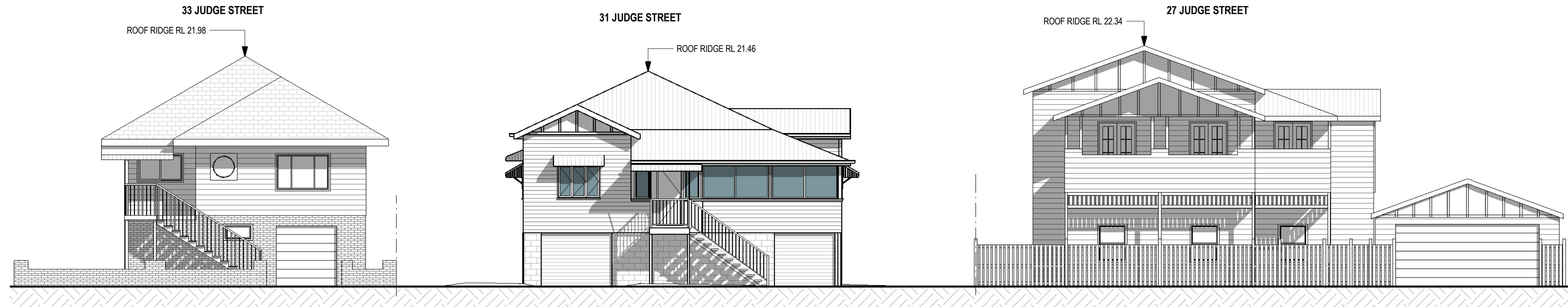

## 1 Existing Streetscape Elevation

1 : 100

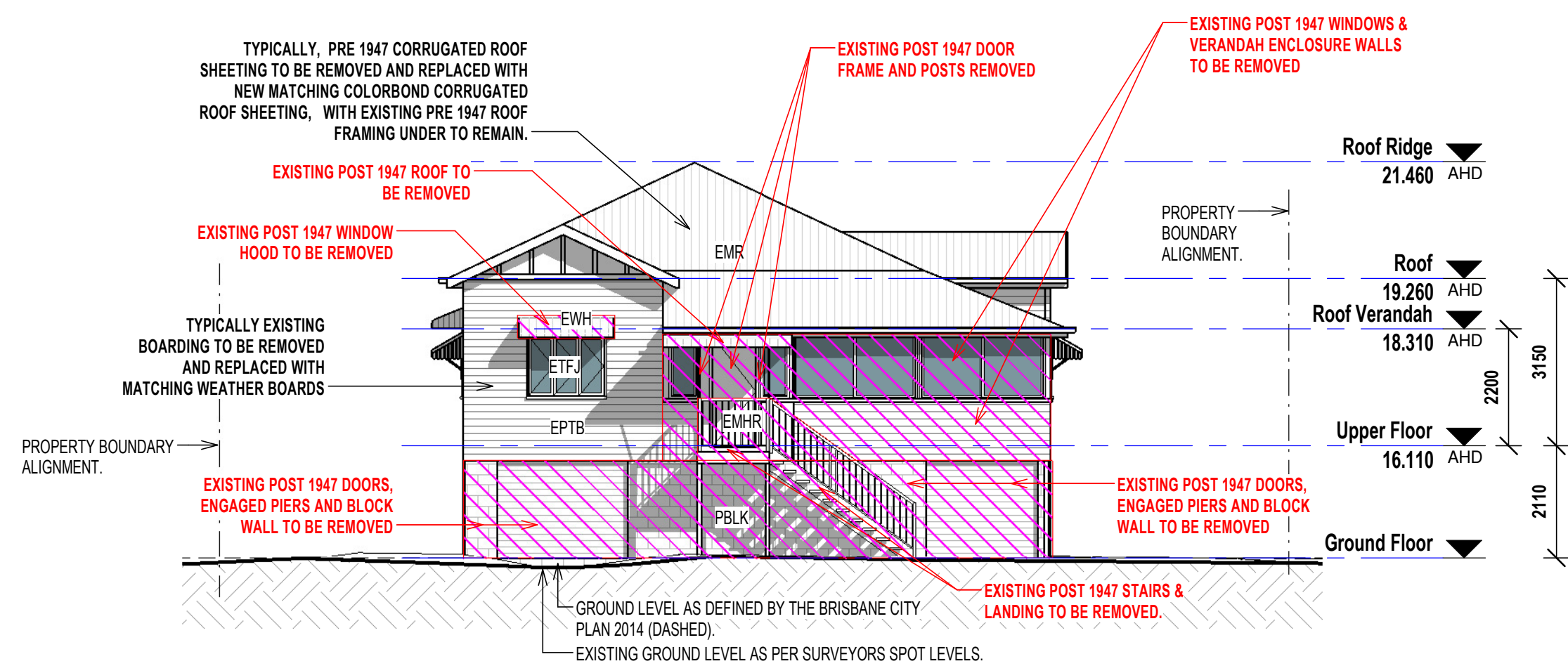

## 2 Existing South Elevation showing Demolition

1 : 100

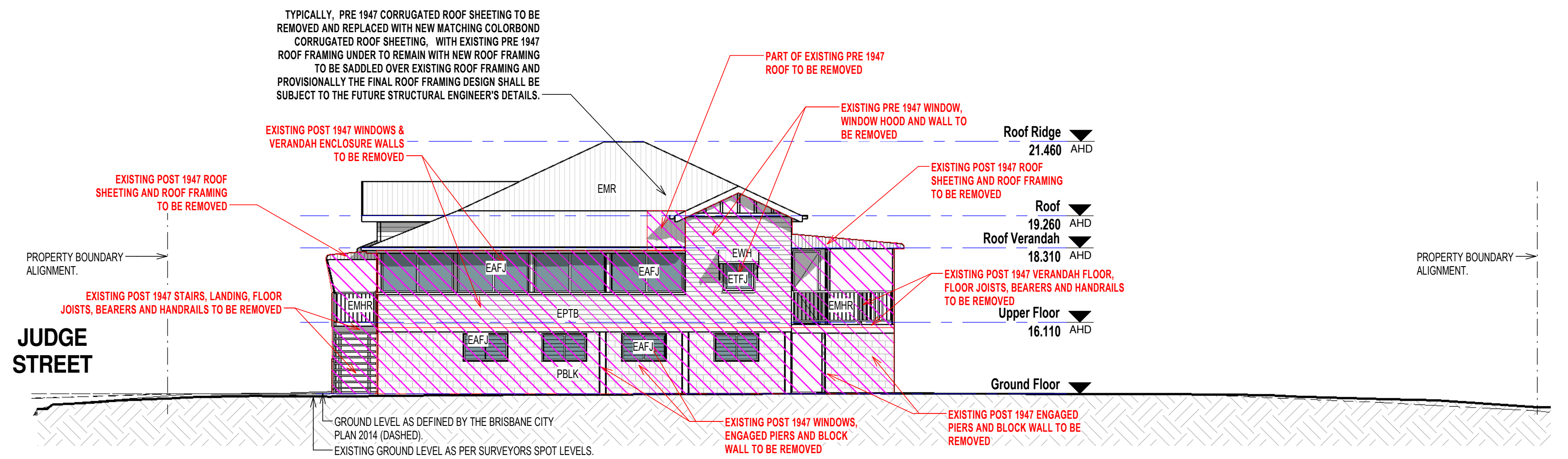

## 3 Existing East Elevation showing Demolition

1 : 100

### MATERIALS LEGEND

EAJ	EXISTING ALUMINIUM FRAMED JOINERY
EMR	EXISTING METAL ROOF SHEETING
EPFC	EXISTING PAINTED FIBROUS CEMENT
EPTB	EXISTING PAINTED TIMBER BOARDING
ETFJ	EXISTING PAINTED TIMBER FRAMED WINDOW JOINERY
EWB	EXISTING WINDOW HOODS
EMHR	EXISTING METAL HANDRAIL
PBLK	EXISTING PAINTED BLOCK WORK

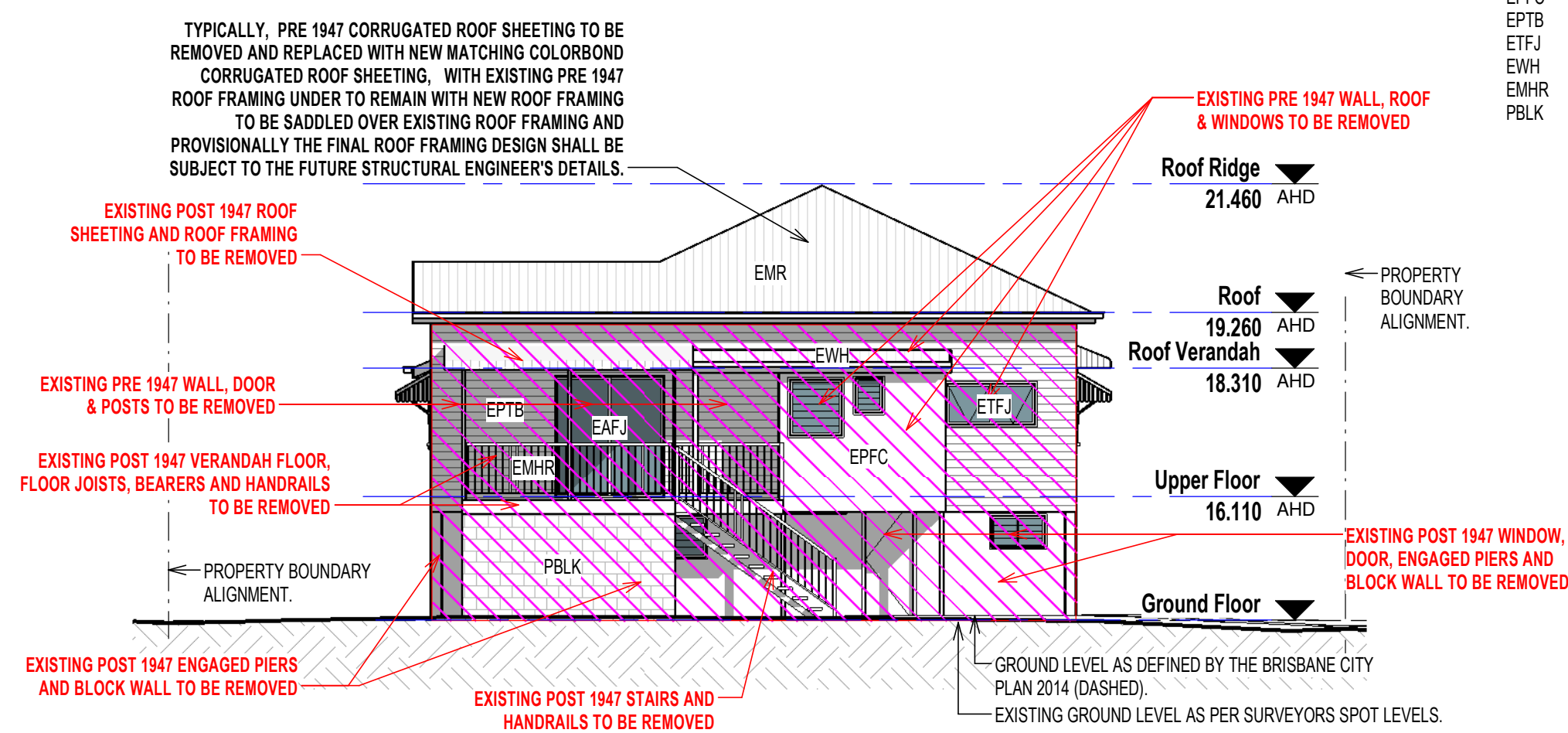

## 4 Existing North Elevation showing Demolition

1 : 100

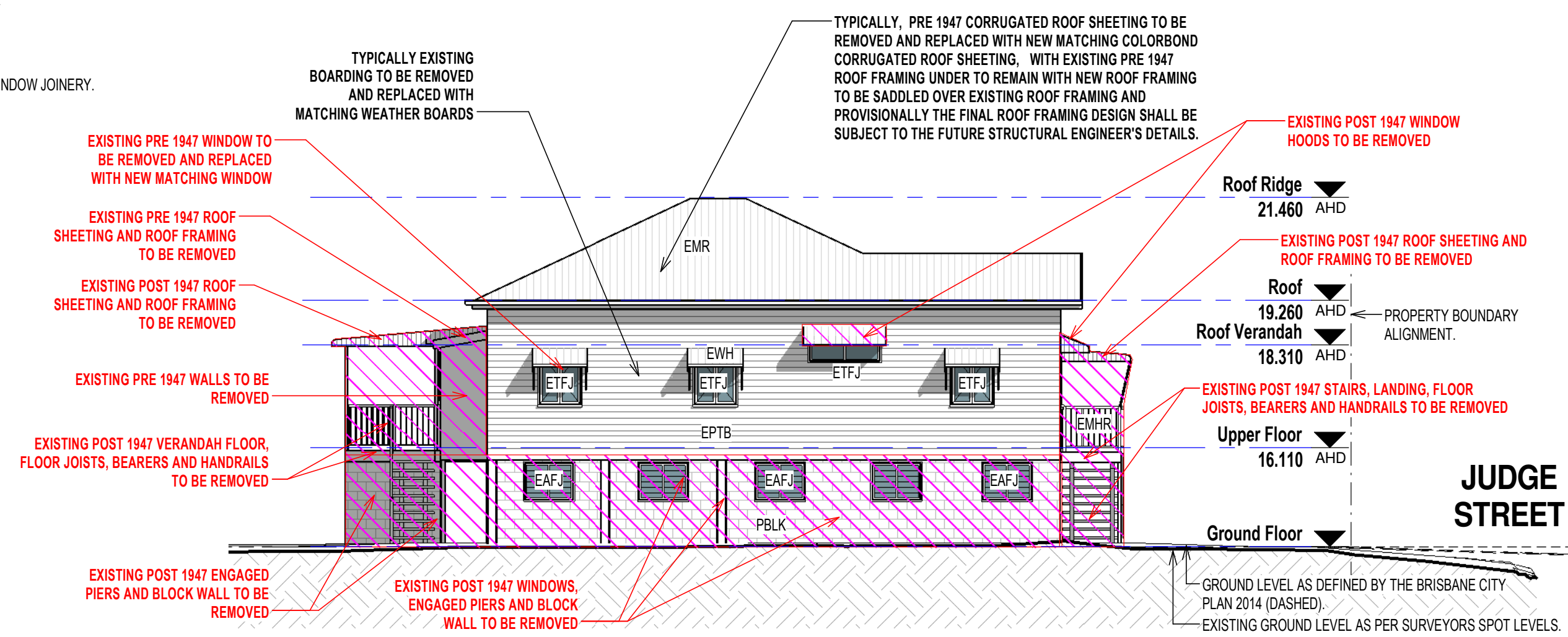

## 5 Existing West Elevation showing Demolition

1 : 100

LODGED  
6/11/2019  
BCC DS

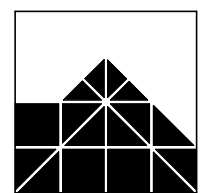

**IAN WEBB**

ARCHITECT  
60 BANKS ST. NEWMARKET Q. 4051  
PH 07 3856 2855 FAX 07 3356 0419

COPYRIGHT:  
THIS DESIGN IS THE  
PROPERTY OF IAN  
WEBB (B.Arch) AND  
SHALL NOT BE  
REPRODUCED WHOLLY  
OR IN PART WITHOUT  
HIS WRITTEN  
PERMISSION.

CLIENT: PROJECT KALINGA  
PROJECT: ADDITION & ALTERATION to EXISTING RESIDENCE  
LOCATION: 31 JUDGE STREET, KALINGA

### AMENDMENTS:

8 Notes amended

01.11.19 TJA

DRAWN BY: LM  
DATE: Nov 2018  
SCALE at A1: 1 : 100  
JOB No: 4142  
SHEET No: SD03  
REVISION: B